

# Burner Collection

## 13" Burner



### Included Accessories



# Burner Collection 13" Burner

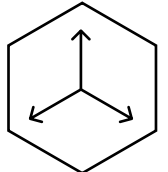
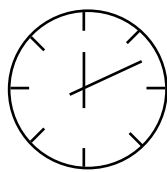
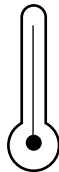
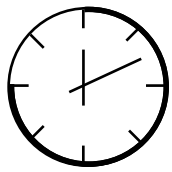
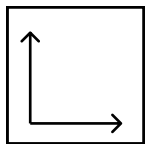
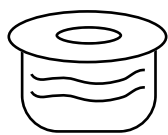
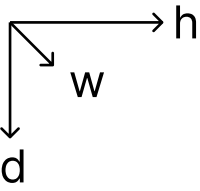

Dimensions H x W x D mm/in	Fuel Capacity	Heats on Average (indoors)	Fuel Consumption	Thermal Output Net (MAX)	Approx. Burn Time	Minimum Room Size (per burner)
49.8×340×130 1.96"× 13.39"×5.12"	0.7L	30-40m <sup>2</sup>	2.14L per hour	10300 BTU 3.0Kw/h	1.5 hour	60m <sup>2</sup>

**Awards** 2010 Winner Outdoor Hearth Products  
Vesta Awards

**Application** Indoor & Outdoor

**Burner Colour**  Stainless Steel

**Materials** Grade 304 Stainless Steel Construction

**Approx. Weight** 7 lbs

**Fuel Type** Bio Ethanol Fuel

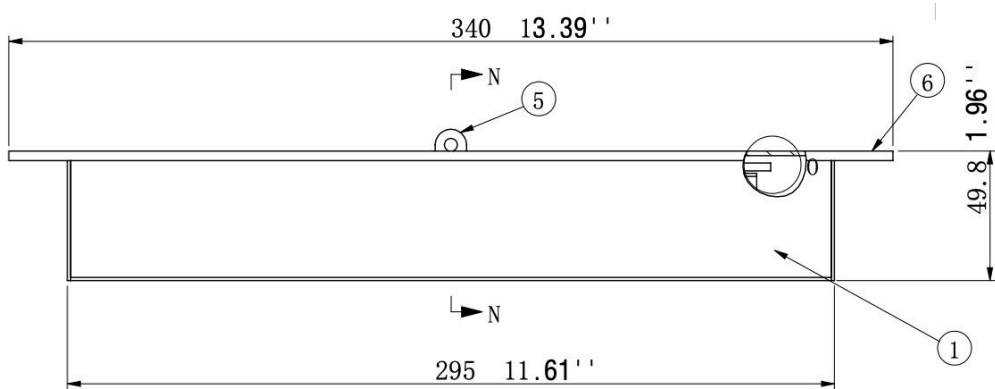
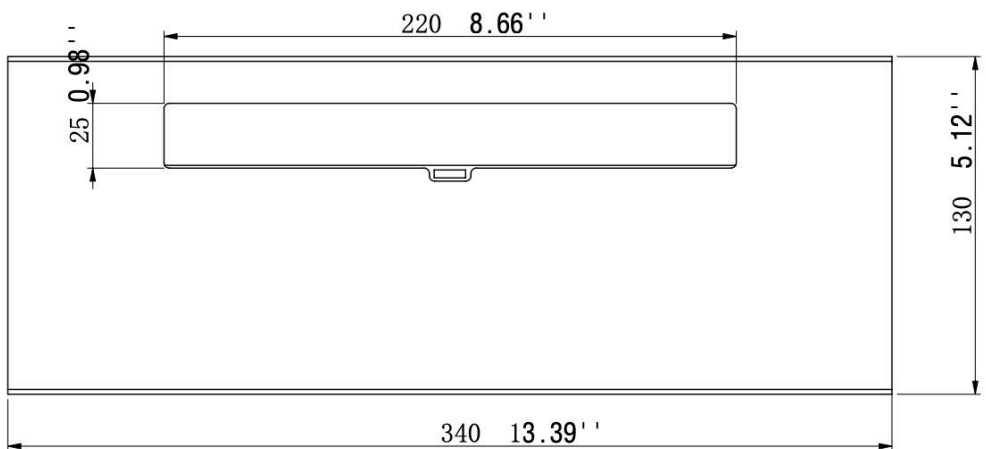

**Inserting within a firebox setting:**  
The Bio Flame 13" BURNER can only be fitted into a non-combustible firebox that has minimum clearances of 21"W x 20"H x 13"D.

**Custom made fireboxes must:**  
- Be made out of a non-combustible material such as stainless steel  
\*When recessing the tray into a non-combustible base with no firebox, the overhead clearance required is 60"MIN. to the nearest combustible\*

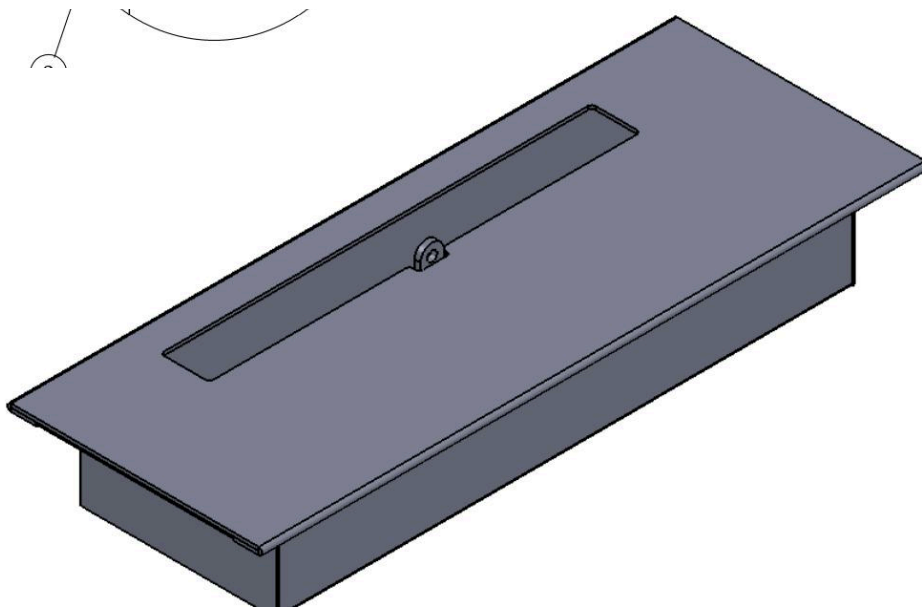
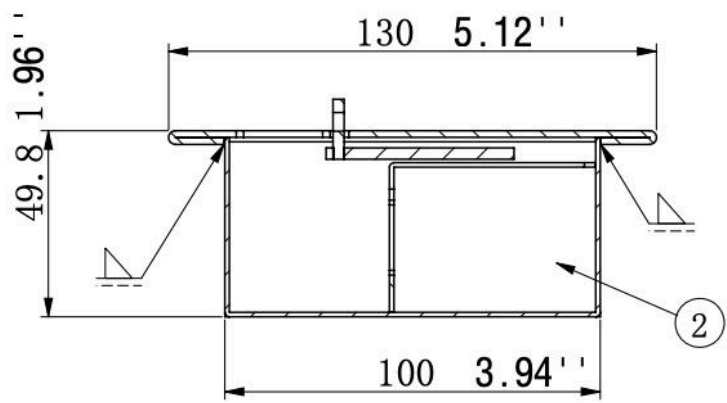

Lifetime Warranty

**FOR MORE INFORMATION PLEASE REFERENCE THE CLEARANCE & INSTALLATION MANUAL**

\*Dimensions may vary by 2% (plus or minus) due to material attributes. Template not provided. The Bio Flame recommends using the actual fireplace or burner model when making final cut out

