

Burner Collection

48" Burner



Black



Included Accessories



Lighting Rod



Lighter



Funnel

Burner Collection 48" Burner

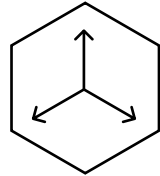
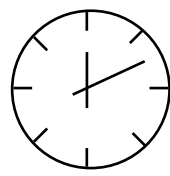
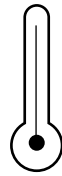
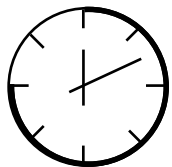
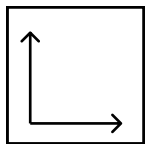
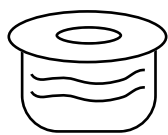
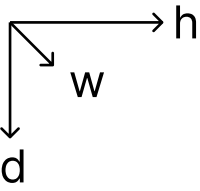

Dimensions H x W x D mm/in	Fuel Capacity	Heats on Average (indoors)	Fuel Consumption	Thermal Output Net (MAX)	Approx. Burn Time	Minimum Room Size (per burner)
116.4×1220×193 4.58"×48.03"×7.6"	14.5L	90-110m ²	0.71L per hour	31200 BTU 9.2Kw/h	10.3 hours	90m ²

Awards 2010 Winner Outdoor Hearth Products
Vesta Awards

Application Indoor & Outdoor

Burner Colour  Stainless Steel  Black

Materials Grade 304 Stainless Steel Construction

Approx. Weight 55 lbs

Fuel Type Bio Ethanol Fuel

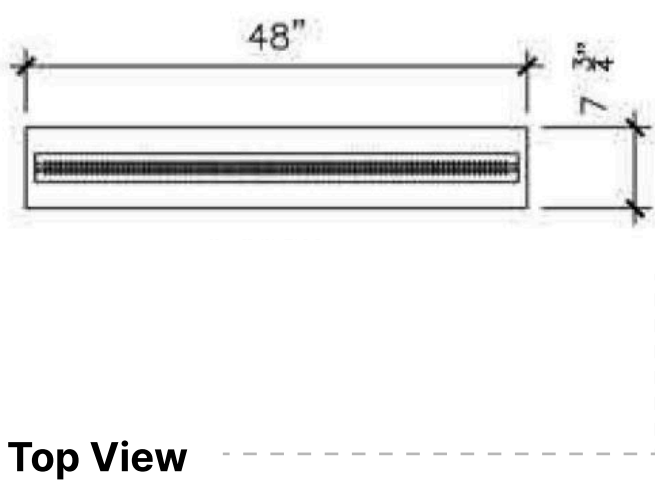
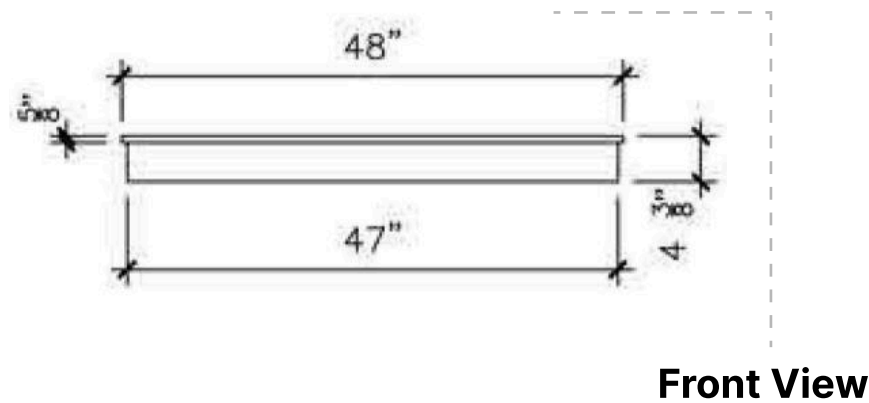

Inserting within a firebox setting:
The Bio Flame 48" BURNER can only be fitted into a non-combustible firebox that has minimum clearances of 56"W x 20"H x 15"D.

Custom made fireboxes must:
- Be made our of a non-combustible material such as stainless steel
When recessing the tray into a non-combustible base with no firebox, the overhead clearance required is 60"MIN. to the nearest combustible

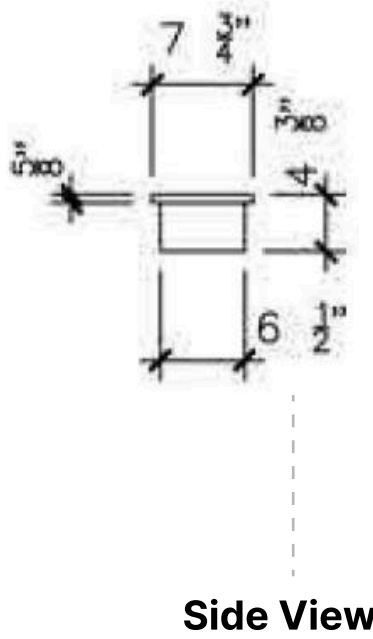

Lifetime Warranty

FOR MORE INFORMATION PLEASE REFERENCE THE CLEARANCE & INSTALLATION MANUAL

*Dimensions may vary by 2% (plus or minus) due to material attributes. Template not provided. The Bio Flame recommends using the actual fireplace or burner model when making final cut out

